

Reviewed for Code Compliance
 2015 IBC, IMC, IPC 2017 NEC 2015 EOC
 Zac Loiseau
 Subject to Field Inspections

ITEM NO.	QTY	EQUIPMENT CATEGORY	EQUIPMENT REMARKS	AMPS	VOLTS	PHASE	DIRECT	PLUG	COLD WATER SIZE (IN)	COLD WATER SERVICE (IN)	HOT WATER SIZE (IN)	HOT WATER SERVICE (IN)	DIRECT DRAIN SIZE (IN)	DIRECT DRAIN AFF (IN)	INDIR DRAIN SIZE (IN)	PLUMBING REMARKS	COMMENTS
006	7	EPOXY COATED WIRE SHELVING	4 TIER SHELVING (24" DEPTH) WITH 74" POST														
007	1	HAND SINK	SOAP & TOWEL DISPENSER BY VENDOR						1/2	12	1/2	12	1 1/2	24			
008	2	EPOXY COATED SHELVING UNIT	4 TIER SHELVING (18" DEPTH) WITH 86" POST														
009	2	EPOXY COATED SHELVING UNIT	4 TIER SHELVING (18" DEPTH) WITH 86" POST														
010	1	SPARE NUMBER															
011	1	WORKTABLE W/ UNDERSHELF	2'-4" X 6'-0"														
011.1	1	SINK WELDED INTO TABLE	FURNISH W/ BASKET DRAIN												1 1/2		
011.2	1	FAUCET							1/2	12	1/2	12					
012	1 OR 2	WALL SHELF	10" X 6'-0". CORE QTY: 2/HIGH-CAP QTY:1														
013	1	COMBI OVEN-STEAMER	W/ EQUIPMENT STAND	16.0	208	3	X		1/2	*					1 1/2	*FROM FILTER ITEM #007	SEE MFR. INFO. FOR HIGH TEMP. PIPING NEEDS
013.1	1	VENTLESS HOOD															
017	1	COFFEE BREWER	BY VENDOR	27.5	120/208	1	X		1/4	*							*FROM FILTER ITEM #018
018	1	WORKTABLE W/ UNDERSHELF															
019	1	2 DOOR REACH-IN REFRIGERATOR	PLUG INTO CO ON WALL	5.4	120	1											
020	1	2 DOOR REACH-IN FREEZER	PLUG INTO CO ON WALL	9.6	120	1											
021	--	SPARE NUMBER															
022A	1	ICE (BASE)	OPTIONAL FULL TABLE	13.8	115	1	X		3/8	*					3/4	*FROM FILTER ITEM #018	
022B	1	ICE (HIGH VOLUME)	OPTIONAL HALF TABLE														
023	1	FILTER SYSTEM	FOR ICE MAKER & COFFEE BREWER														
024	1	THREE COMPARTMENT SINK	FURNISH W/ BASKET DRAINS						3/4	48					(3) 1 1/2		
024.1	1	FAUCET AND PRE-RINSE							1/2								
025	1	WALL SHELF	10" X 7'-10"														
026	1	UNDERCOUNTER WAREWASHER		30.0	220-240	1	X			3/4	12				1		
027	1	EPOXY COATED SHELVING UNIT	4 TIER SHELVING (21" DEPTH) WITH 74" POST														
028	1	PAN RACK															HIGH-CAPACITY LAYOUT ONLY

NOTE: ALL EQUIPMENT SHALL BE NSF/ANSI CERTIFIED, TYPICAL.

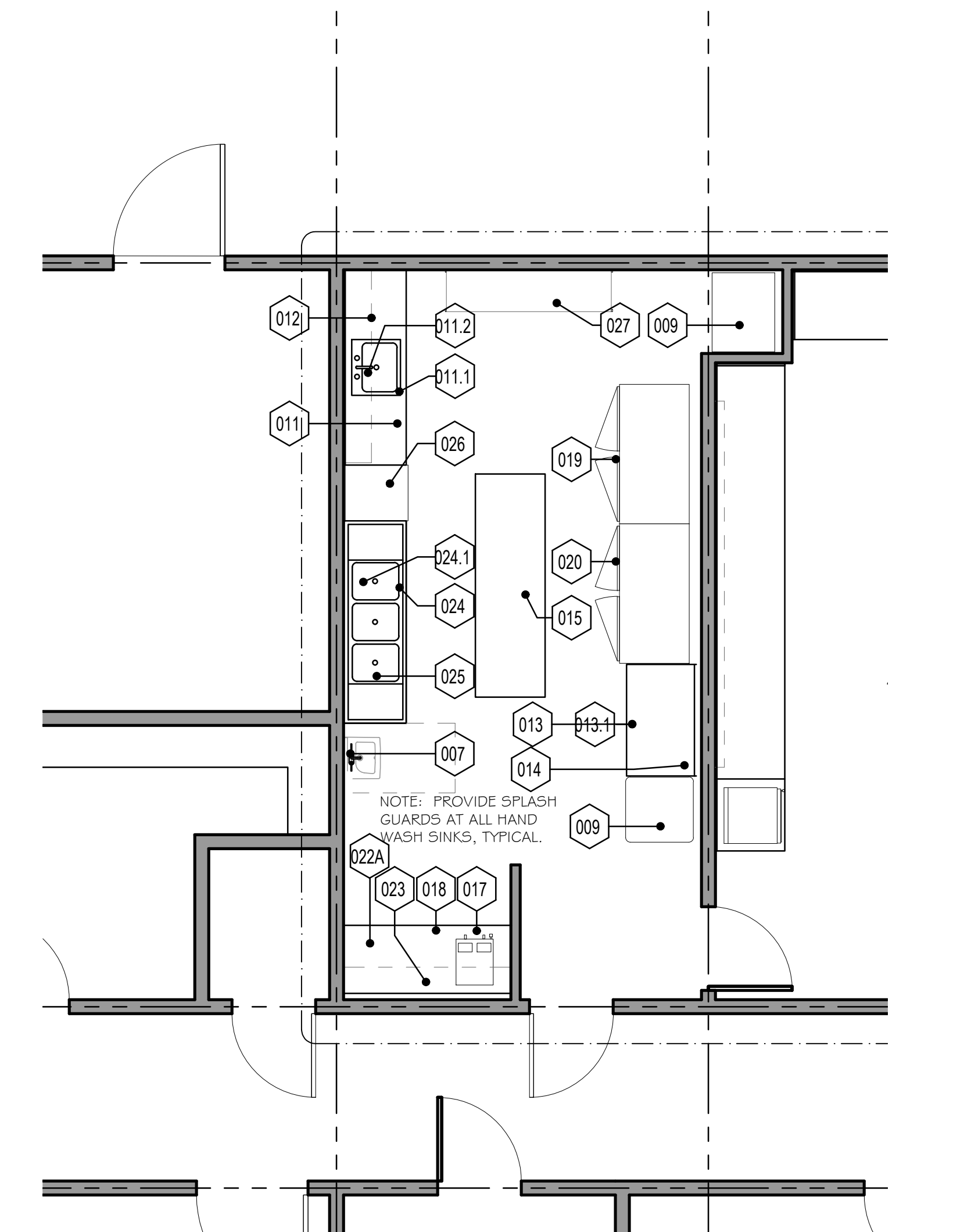

1 ENLARGED FOOD PREP PLAN
 SCALE: 1/4" = 1'-0"

REVISION NO.

HOLIDAY INN EXPRESS
 850 NORTHSIDE DRIVE
 PILOT POINT, TEXAS 76258

LOCATION
 91024

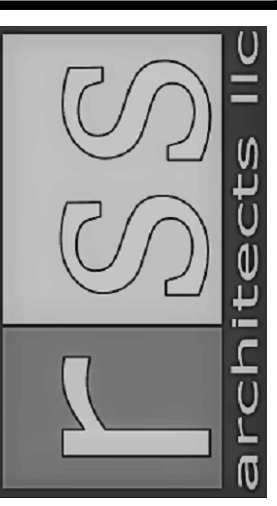

RSS-ARCHITECTS.COM
 817/538-9258

Date 1-17-2024

Job 22020

Sheet

K-101